

ORA 600

USER MANUAL

Tankless Non-Electric RO Filtration System





CONTENTS

1. Before Installation	01
2. Packing List	02
3. Product Introduction	03
4. Sample Connection	03
5. Installation Tips and Precautions	04
6. Installation Steps	05
7. Display And Operation	10
8. Replacement Of Filter Cartridge	12
9. Filter Replacement Instruction	12
10. Product Dimension	14
11. Maintenance	15
12. Troubleshooting	16
13. Frequently Asked Questions	17
14. Limited Warranty	18



BEFORE INSTALLATION

Inspect Box

Open the box and take out the system and all the components. Inspect them carefully according to "Product Introduction" and make sure nothing is missing or damaged during shipping. If any parts are cracked or broken, please do not proceed with the installation and contact us for an exchange or diagnosis.

Technical Parameters

Model	Ora 600
Size (L*W*H)	14.5"×5.2"×18.6"
Daily Production Rate	600-900 gallons @45~60psi (25°C)
Applicable Water Source	Municipal Tap Water
Working Pressure	3.0~7.0bar
Water Temperature	5-38°C
Battery Capacity	4500 mAh
Rated Voltage/Current	5V/19mA
*Actual GPD (gallons per day) varies with inlet water pressure - higher pressure results in greater flow rate.	



NOTE: Battery powered display only (No power required for product operation). Low water temperature will slow down water flow.



PACKING LIST

Preinstalled



System Housing Set x1



PPC Filter x1



RO Filter x1



Post carbon Filter x1



RO Faucet Set x1



Feed Water Valve x1



3/8" Inlet Hose x1



1/2"-3/8"
Converter Set x1



1/4"-1/4" quick
water fitting x2



Elbow fitting 1/4" stem -
1/4" quick connect x2



USB Type-C Cable x1



Drain Saddle x1



Plumber Tape x1



Wrench



White 1/4" tubing x1



Red 1/4" tubing x1



Blade x1



Lock Clips



PRODUCT INTRODUCTION

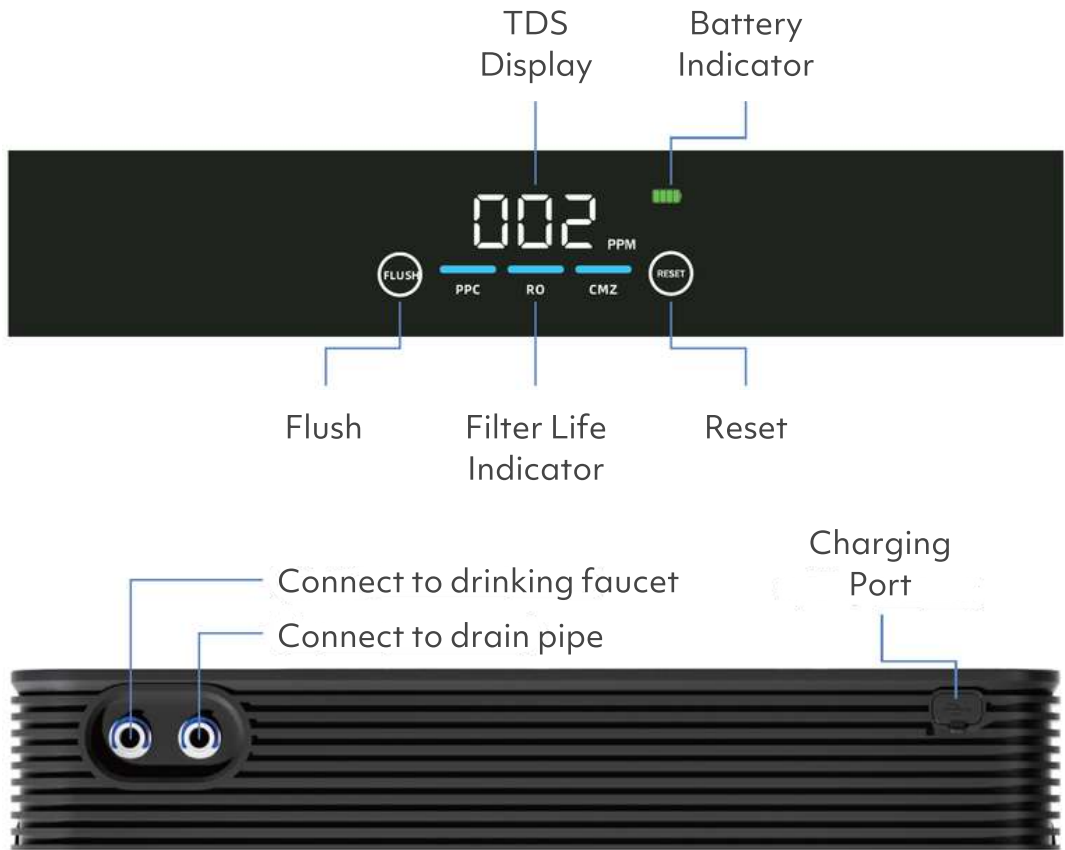

SAMPLE CONNECTION

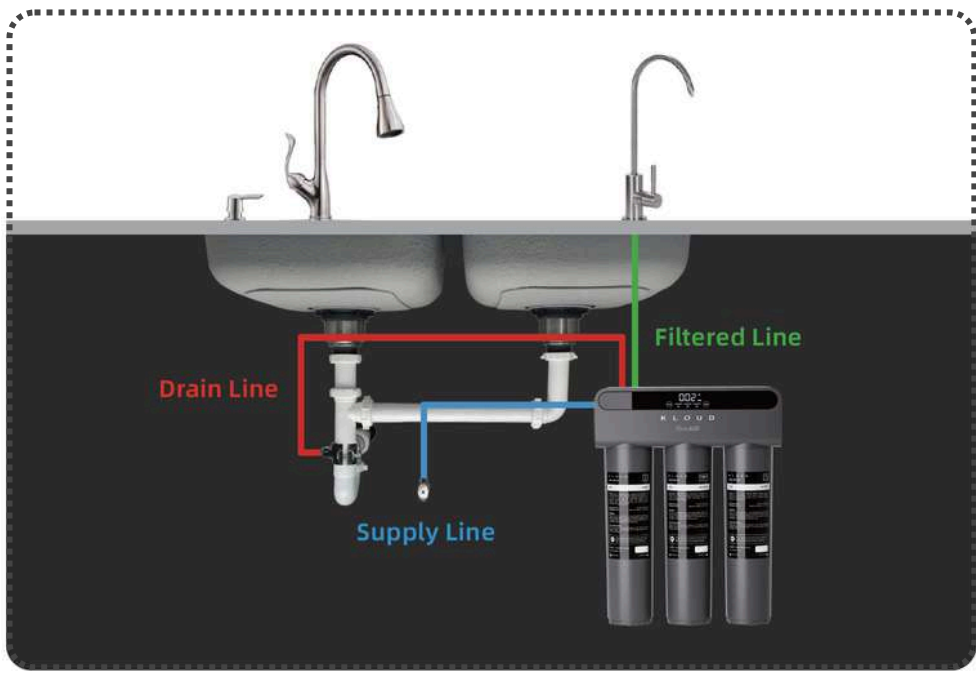



INSTALLATION TIPS AND PRECAUTIONS

How to cut the tubing?

Please cut the tubing into two sections in proper length, make sure cut them squarely and cleanly.

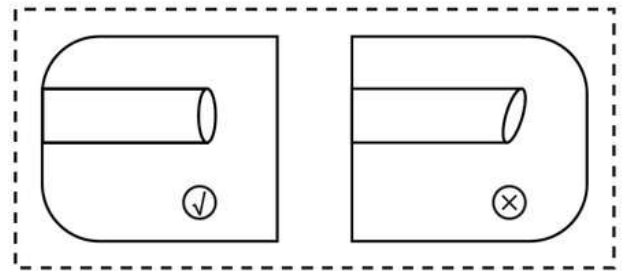

How to connect/disconnect the tubing?

TO CONNECT: Please push the tubing into the fitting and make sure it is fully inserted. Then put the blue lock clip on the fitting, it will lock the tubing in place.

TO DISCONNECT: Please remove the blue lock clip from the fitting, push in the lock sleeve, and then pull out the tube from the fitting.



NOTE: If the tubing is not fully inserted, water leakage may occur. Pulling out the tubing directly will damage the fitting, which may also cause water leakage.

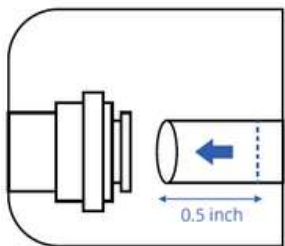

1. Insert to seal the connection

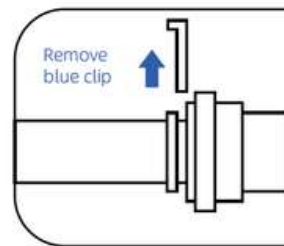
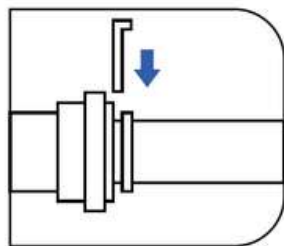

2. Remove to disconnect

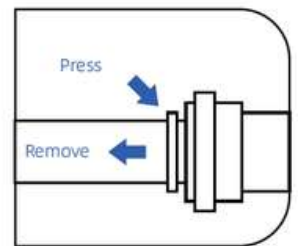



Precautions

- Do not use with water that is microbiologically unsafe or of unknown quality without adequate disinfection.
- Testing was performed under standard laboratory conditions. Actual performance may vary.
- For cold water use only.
- This filter must be protected from freezing, which can cause cracking of the filter and water leakage.
- Do not allow children under 3 years of age to have access to small parts during installation.
- The installation must comply with all applicable state and local regulations.

INSTALLATION STEPS

Step 1: Activate Screen

- Activate screen.
- Long Press “” + “” for 4s.

Step 2: Mount The System (Optional)

- Use the screws provided to mount the system.



NOTE: Mount the water filter at least 2 inches higher than the ground for easier filter replacement.

- Fasten the screws.



Step3: Connect The Water Hose

Connect the inlet hose to the "Inlet" port.



Step4: Connect three-way feed water valve (3/8" or 1/2")

Connect the "inlet hose" into the 3-way feed water valve.



Step5: Connect the water supply (COLD WATER ONLY)

- Shut off the water supply. Disconnect the cold water pipe from angle valve.
- Twist the feed water valve onto the angle valve and make sure the O ring is loaded.
- Connect cold water pipe onto the feed water valve. Valve installation complete





NOTE: If your angle valve is 1/2", please install the converter provided firstly.



Step6: Cut the 1/4" red tubing

Please cut the 1/4" red tubing in proper length, make sure cut them squarely and cleanly.

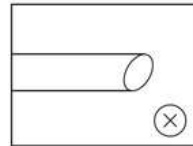
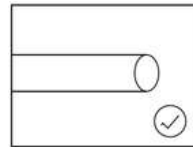

Step7: Install the drain saddle

- Disassemble the drain saddle, and peel off the black sticker and stick to saddle valve.
- Choose a spot on the drain pipe that is convenient for installing the drain saddle. It is recommended to install the drain saddle on the vertical drain pipe.
- Drill a 1/4" hole in the drain pipe. Make sure not to penetrate the opposite side of the pipe.





- Mount the drain saddle and tighten the screws with a screw driver.



- Insert the 1/4" red tubing to the drain saddle about 1.4", and lock the fitting with a blue clip.



Step8: Connect the "WASTE" water tubing

Cut the 1/4" red tubing in proper length and insert one end into the "Wasted" port on the back of the system. Then lock the clips.



Step9: Install the drinking RO faucet



NOTE: If your kitchen sink or countertop does not have an existing hole, you will have to drill one (1/2") before proceeding .



Follow the steps below and mount the faucet onto the sink top.



Mount the rubber and fasten the hand fixture underneath.



Step10: Connect the "FILTERED" water tubing

Cut another 1/4" tubing in proper length. Insert one end into the "Filtered" port on top of the system. Then lock the clips.



Connect the other end of 1/4" white tubing from the "FILTERED" port into the 1/4" quick fitting. Then lock the clips





Step11: Start up the system

Turn on the angle valve and check for leaks.



Step12: First time usage

Turn on the RO faucet. Allow it to run for 20 minutes

DISPLAY AND OPERATION

Display Activation

- Long Press “  ” + “  ” for 4s.



NOTE: When the display is “OFF”, the system does not track filter lifespan. For accurate filter life monitoring, please keep the display activation during regular use.

Filter life indicator

Filter life indicator on the system housing.





Status	Remaining Life	Indication	
		Light	Buzzer
Normal	> 15 Days	Blue	/
Warning	< 15 Days	Flashing Blue	Beeps for 30s every 3 hours

Filter Life Reset

- **SELECT FILTER:** Long press the "RESET" for 2 seconds, the buzzer will beep and you can start to select the filter you want to change. Press "RESET" to change between the filters and the selected filter lifetime indicator will flash.
- **RESET:** After selecting the filter, long press "RESET" button for 4 seconds. You will hear a beep which means the filter is successfully reset. If you do not operate within 5 seconds, it will automatically exit this mode and resume normal display.

Flush Mode

- Press the "FLUSH" button once to activate the flush mode for 30 seconds.
- Press the "FLUSH" button again during this process to stop flushing immediately.

Automatic Flushing

- **FLUSH FOR STANDBY STATUS:** To maintain and extend the life expectancy of the filters, when the system is in standby status, the system will be automatically flushed for 30 seconds every 24 hours.



NOTE: Flush the RO unit at regular intervals to ensure the longest possible service life of the membrane. To do this, use a convenient flush valve. In addition, we recommend that you flush the membrane for approx. 1 minute before each RO water treatment.

REPLACEMENT OF FILTER CARTRIDGE

Please replace filter cartridges regularly according to the recommended replacement period shown below.

Position	Filter	Model Number	Replacement Period
1st stage	PP+CB 2-in-1 filter	ORA 600-PC	up to 4-6 Months
2nd stage	RO membrane	ORA 600-RO	up to 18-24 Months
3rd stage	Post Carbon Filter	ORA 600-CB	up to 8-12 Months



NOTE: All the service life of the filter cartridge listed are based on actual laboratory test and the provided water. The actual service life of filter cartridge depends on source water quality and daily water usage.

FILTER REPLACEMENT INSTRUCTION

Step 1: Turn off the water valve and turn on the water faucet to release water pressure

Cut off the water supply.







Turn on the RO water faucet to release water pressure.



Firstly twist the housing clockwise. Secondly take another replaceable filter and twist the housing counterclockwise.



Step 2: Reset the filter lifetime

- Long press the "  " button for 2 seconds, the buzzer will beep and you can start to select the filter you want to change.
- Press "  " button to change between the filters and the selected filter lifetime indicator will flash.
- After selecting the filter, long press "  " button for 4 seconds. You will hear a beep which means the filter is successfully reset. If you do not operate within 5 seconds, it will automatically exit this mode and resume normal display.

Step 3: Flush the filter

- Turn on the faucet to discharge the filtered water. If you replace the RO membrane, please do not use the water in the first 20 minutes. If you replace other cartridges, please do not use the water in the first 10 minutes.



PRODUCT DIMENSION





MAINTENANCE

1. Do not use with water that is microbiologically unsafe or of unknown quality without adequate disinfection.
2. If you don't use the system for a long time.
 - If the system has not been used for more than 2 days, please turn on the faucet and discharge the filtered water at least 5 minutes before usage.
 - If the system will not be used for more than 1 week, please seal the filter cartridges and store them in the refrigerator but do not put them in the freezer. Discharge filtered water for at least 10 minutes before next time usage.
 - If the system will be not used for a long time, please cut off the water supply, cut off the power and turn on the handle of the faucet to release the internal pressure and avoid damage to the system.
3. Please replace the filter cartridge regularly according to the filter life indicator.
4. The testing was performed under standard laboratory conditions, actual performance may vary depending on the source water quality and water usage. In case of premature blockage and failure of the filters, it is recommended to replace the filter in accordance with actual usage.
5. Clean the system with clear water. Do not spray the water directly. Do not use steel wool, abrasive cleaner or corrosive liquid into the filter to avoid damage to the filter system.
6. Keep the waste water pipe unobstructed to avoid damage to the filter or internal components.
7. When the drain pipe is blocked, do not use the system to avoid the waste water from soaking the floor.
8. Check the system and water pipe fittings regularly for water leakage to avoid any property damage.



TROUBLESHOOTING

Fault	Possible Cause	Solution
No water out of faucet	Cold water valve or the faucet is off.	Please open the valves.
	Connection of pipeline is incorrect.	Please check the pipelines and make sure the connection is correct.
Low water flow	Lifetime of the filter cartridge is expired.	Please replace the filter cartridge or contact customer service team.
	Filter is blocked.	Please replace the filter according to the instruction.
	Water pressure is low, or water supply is insufficient.	Please contact customer service team.
	PE pipes are bent.	Please check PE pipes.
Filtered water in poor quality	Lifetime of the filter cartridge is expired.	Please replace the filter according to the instruction.
	Quality of feed water is too bad.	Please ensure the water source is municipally treated water or has been properly disinfected prior use.
Water leakage	Pipes or filters are not installed properly.	Please reinstall the system according to the instruction or contact customer service team.
	The O rings are missed.	Please contact customer service team.
	Other components are damaged.	Please contact customer service team.
Unchanged filter lifetime indicator	Electronic controller or display panel is damaged.	Please contact customer service team.
Button failure	The button is misoperated.	Please operate the button according to the instruction.
	The button is damaged.	Please contact customer service team.
Indicators on user interface disappear	Battery level is insufficient.	Please charge the display in time.
	The panel is damaged or it's cable is loose.	Please contact customer service team.



FREQUENTLY ASKED QUESTIONS

? Why there are many white bubbles in the water?

Normally for the first time use of the RO system, the water seems to have white bubbles in it, which is normal and totally drinkable. Because when water passes through the RO membrane, it also turns the air in the water into small molecular bubbles. The air can't be released at that time because of the pressure in the RO system. However, when you turn on the tap to get a cup of water, the pressure of air is released. So you will see a huge number of bubbles in the water. It looks cloudy and white, but they are just bubbles. After you put the water still for a while, all bubbles will be gone, the water is totally good for drinking.

? Why TDS is higher at the beginning, but back to normal range after about one minute?

Osmosis is a natural phenomenon that occurs in all RO systems, whether conventional or tankless. When the RO system starts, the natural osmotic pressure is overcome by the system's unique design, allowing feed water to pass through the RO membrane and remove impurities. When the system stops, the absence of external pressure means a small fraction of ions may temporarily cross the membrane due to concentration differences, causing a slight TDS increase. Even if the TDS is initially slightly higher, the water quality remains far superior to other filtration methods (carbon, KDF, ceramic, UF, UV, etc.). The water is safe to drink immediately—no need to wait—as the system never releases harmful substances. The ORA 600 maintains a 94–95% TDS removal rate; if the input TDS is high, the output will reflect this proportionally.

? How does the TDS display on the Machine work?

When the system is running, the TDS sensor in the ORA 600 will keep testing the water quality every 30 seconds. Therefore, the TDS result you see from the machine is from the last test memory. If you want to have the real-time TDS result, please let the machine run for about 30 seconds.



? Why the system does not work after connecting the water pipes?

Maybe you did not open the cold water valve or did not open the RO faucet.

? Why there is difference between the TDS Reading Tested by the TDS Meter and the Displayed Reading?

The reading tested by the TDS Meter is the TDS of static water in the container while the TDS reading displayed by the system is the TDS of flowing water. As a result, the TDS readings are different. Or there are errors in the TDS Meter tests.

LIMITED WARRANTY

One Year Warranty

Octopus First General Trading LLC (referred herein as “Kloudfilter”) provides a one-year limited warranty from the purchase date as per the sales invoice or receipt issued by Kloudfilter. Kloudfilter reserves the right to either replace defective products and/or parts with new ones or repair defective products or parts at its sole discretion. Repair or replacement of defective products is determined after inspection of the product. However, Kloudfilter will always attempt to repair defective products before replacing them with new ones. All products and parts that are replaced become the property of Kloudfilter. Repair or replacement of defective products under this warranty does not extend or renew the warranty period; the original purchase date will still be considered for future warranty claims. Kloudfilter reserves the right to charge a service fee for any warranty repair/service, and this warranty applies only to defects in material, design, and workmanship.



This warranty does not cover:

1. Periodic checks, maintenance, no-fault-found cases, and repair or replacement of parts due to normal wear and tear.
2. Abuse or misuse, including but not limited to failure to use the product for its intended purposes or in accordance with Kloudfilter product instructions on usage and maintenance.
3. Defects resulting from the use of the product with accessories not approved by Kloudfilter.
4. Failure of the product arising from incorrect use not consistent with the instructions and technical safety standards prescribed in the product user manual.
5. Accidents, Acts of God, lightning, water, fire, public disturbances, improper ventilation, voltage fluctuations, or any cause beyond the control of Kloudfilter (“Force Majeure”).
6. Unauthorized modifications carried out to the product to comply with local or international technical standards in countries for which this Kloudfilter product was not originally designed.
7. Cases where the serial number on the product has been altered, deleted, removed, or made illegible.
8. Consumables (components expected to require periodic replacement during the lifetime of the product, such as non-rechargeable batteries, replacement filters, etc.).
9. Neglect.

Limitations and Exclusions:

If any exclusion is not permitted by applicable law, Kloudfilter limits its warranty only to the maximum extent permitted by law. Any warranty that cannot be fully excluded will be limited to the duration of this warranty.

Kloudfilter obligation under this warranty is limited to repair or replacement of products subject to these warranty terms and conditions. Kloudfilter shall not be liable for any loss or damage relating to products or services covered by this warranty, including economic or intangible losses—the price paid for the product—loss of profits, revenue, data, enjoyment, or use of the product, and indirect, incidental, or consequential loss or damage.

This warranty is not transferable. It represents the purchaser’s sole and exclusive remedy, and Kloudfilter shall not be liable for any incidental or consequential damages for breach of any express or implied warranty of this product.

K L O U D

Ora 600



KLOUD™ | DESIGNED IN UAE

www.kloudfilter.com

Water, The Way It *Should* Be _____ 